



2017 | HIA-CSR AUSTRALIAN HOUSING AWARDS



The 2017 HIA-CSR Australian Housing Awards showcase creativity, innovation and excellence in construction and design that has become synonymous with Housing Industry Association (HIA) members.

Winners have come from across the country and are a testament to the professionalism and talent available in Australia. The projects are sure to impress and inspire you.



HIA-CSR Australian Home of the Year	4
HIA Australian Custom Built Home	8
HIA Australian Display Home	10
HIA Australian Project Home	12
HIA Australian Spec Home	14
HIA Australian Renovation/Addition Project	16
HIA Australian Townhouse/Villa of the Year	18
HIA Australian Apartment of the Year	20
HIA Australian Townhouse/Villa Development	22
HIA Australian Apartment Complex	24
HIA Australian Specialised Housing	26
HIA Australian Outdoor Project	28
HIA Australian Kitchen Design	30
HIA Australian Kitchen of the Year	32
HIA Australian Bathroom Design	34
HIA Australian Bathroom of the Year	36
HIA Jim Brookes Australian Apprentice	38
HIA Australian Business Partner	39
HIA Australian Professional Major Builder	40
HIA Australian Professional Medium Builder/Renovator	41
HIA Australian Professional Small Builder/Renovator	42

2017 | HIA-CSR AUSTRALIAN HOUSING AWARDS

CSR

Building great spaces to live, work and play

CSR provides the building solutions to create homes where people live, work and play. Our scale and network helps you, the builder, to create great homes. We work with you to reduce construction time and deliver better energy efficiency, comfort and design, so that you can build great spaces to live, work and play.

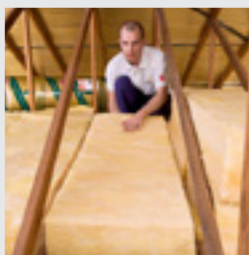

Bradford™ is more than just insulation, providing acoustic control and energy saving products for homes.



Gyprock® and Cemintel™ for all internal and external linings to optimise the look and the performance of a home.

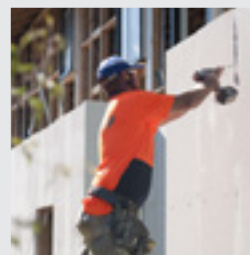

Hebel® provides the builder the advantage of a shorter building programme reducing installation time and reducing the requirements for steel framework.



Monier's Elemental™ Series provides the perfect look, performance and easy installation. Rust-resistant, strong, and durable to protect your family from the Australian elements.

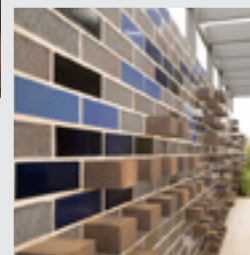

PGH™ Bricks offers a range of over 180 colours and sizes. From timeless dry pressed to vibrant glazed, through to the earthiness of sandstock bricks.

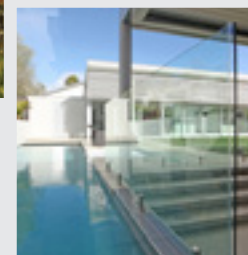

Viridian™ provides a range of residential glass including double glazed windows, laminated, energy-efficient, safety, security and self-cleaning glass.

Bradford™
more than insulation

CEMINTEL®

EDMONDS
Technologies for a Sustainable Future

GYPROCK™
Everything else is just plasterboard

hebel
The better way to build

MONIER™

PGH BRICKS & PAVERS

VELOCITY

Viridian™
New World Glass

For further information on CSR's range of building materials in Australia call 1800 633 826 or visit www.csr.com.au/building-solutions/detached-homes



2017 | HIA-CSR AUSTRALIAN HOME OF THE YEAR

WINNER





SPADACCINI HOMES

Western Australia

The 2017 HIA-CSR Australian Home is a dream – luxurious and immaculate, yet warm with a comfortable, liveable design.

Three levels feature five bedrooms and bathrooms; gym and sauna, ‘infresco’ entertaining with a suspended plunge pool. Faultless workmanship and detail like marble flooring, stone cladding and glass mosaics shows true collaboration between client and builder. A PV system with a custom-made German home automation system controls energy use, from the security and windows to water filtration.

www.spadaccinihomes.com.au

Partnered by



WINNER

2017 | HIA-CSR AUSTRALIAN HOME OF THE YEAR

FINALISTS



SPACE CONSTRUCTIONS Queensland

At the forefront of urban renewal in a beautiful area of Brisbane, this bold display home stands out with a striking exterior, utilising the latest low-maintenance cladding materials, such as metal cladding, to its best advantage. The judges noted that the clever use of double-height glazing and a striking feature stone wall delivers a 'wow' factor as the living area unfolds.

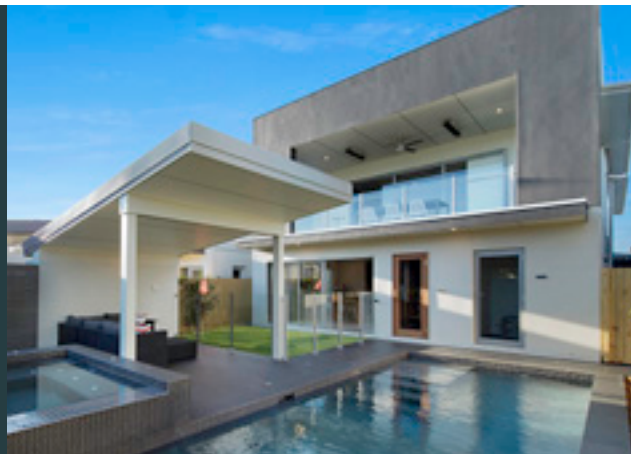

PLANBUILD HOMES Queensland

The Epernay project home presents a modern interpretation of the classic Hamptons' house style, perfectly designed to maximise the space of a smaller lot. The elegant, expansive five-bedroom home gives more than enough space for a family, with two large living areas on the ground floor offering access to a stunning entertainment area complete with an outdoor pool, spa and steam room. And the views...breathless.



AVERNA HOMES Western Australia

This street-smart modern Perth home cleverly balances dark and light tones with its crafted timbers and distinctive renders. Meticulously built with a design that will gracefully age, the home's two-storey façade of white porcelain contrasts with a horizontal black-rendered feature, and cedar board lined eaves. Sharp lines and striking colour palette are reminiscent of renowned architect, Frank Lloyd Wright.

Partnered by



FINALISTS



JW CONSTRUCTIONS (QLD) Queensland

A show-stopper both in skill and sophistication. An expansive cantilevered roof and balcony impresses on arrival. Entering the home's light and bright atmosphere will delight and beg exploration, offering plenty of areas which incorporate clever design. Floor-to-ceiling windows and the open plan layout drink in the coastal views making entertaining a breeze, as you look out onto the wet-edge pool.



ELLIOTT PROJECTS New South Wales

This contemporary four-bedroom townhouse sits in a leafy Sydney suburb, offering a smartly designed to offer a spacious and light-filled interior. It stands apart from neighbouring terraces with its stacking windows, fully recessed into pockets and a welcoming handmade timber door entrance, set off by timeless zinc panel cladding.

The build was challenging: neighbouring properties had to be underpinned but the evidence is beautifully masked with a large stone retaining wall – a prominent feature to the sunny rear courtyard.



HELM New South Wales

The HIA Australian Apartment of the Year is part of a mixed use development in Sydney's inner west, meticulously crafted with attention given to the smallest details.

The 244-square metre three-bedroom apartment promotes cross-ventilation and great acoustics for the resident's comfort. Well-positioned windows and sunshades offer views as well as privacy. High 3.6-metre ceilings with skylights, well-polished limestone flooring, marble benchtops in the kitchen were considered standout elements by the judges.

2017 | HIA AUSTRALIAN
CUSTOM BUILT HOME

WINNER



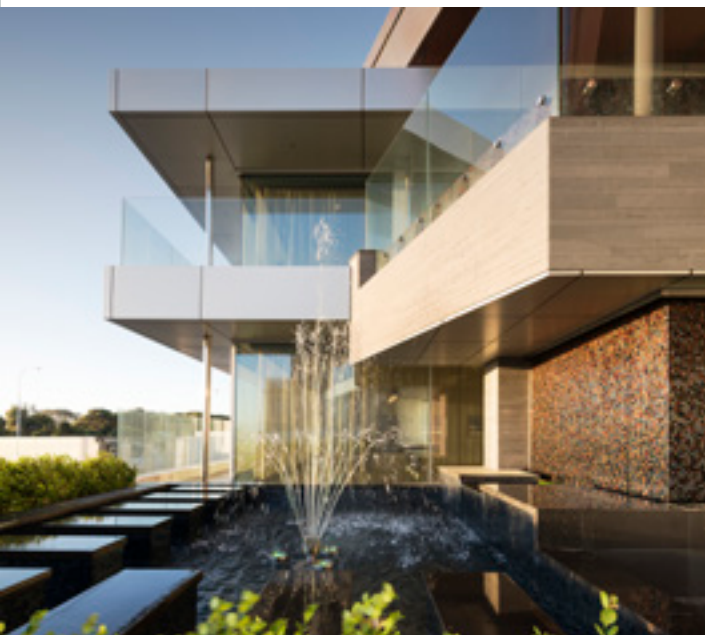

WINNER

WINNER: SPADACCINI HOMES Western Australia

The 2017 HIA-CSR Australian Home is luxurious and immaculate, yet warm with a comfortable, liveable design.

Three levels feature five bedrooms and bathrooms; gym and sauna, 'infresco' entertaining with a suspended plunge pool. A highly detailed glass lift connects to the 10-car display garage. Faultless workmanship and detail like marble flooring, stone cladding and glass mosaics shows true collaboration between client and builder.

www.spadaccinihomes.com.au

2017 HIA AUSTRALIAN CUSTOM BUILT HOME FINALISTS

Preferred Builders, DNA Architects &
Braithwaite Innovative Joinery [ACT/Southern NSW](#)
Millbrook Homes [Hunter](#)
Ash Moseley Homes [North QLD](#)
ACG Building [NSW](#)
Overlander Homes [NT](#)
Mosaic Construction [QLD](#)
Lang Homes [SA](#)
Cordwell Lane [TAS](#)
Visioneer Builders [VIC](#)

Partnered by



2017 | HIA AUSTRALIAN DISPLAY HOME

WINNER



WINNER: SPACE CONSTRUCTIONS Queensland

At the forefront of urban renewal in a beautiful area of Brisbane, this bold display home stands out with a striking exterior, utilising the latest low-maintenance cladding materials, such as metal cladding, to its best advantage. The judges noted that the clever use of double-height glazing and a striking feature stone wall delivers a 'wow' factor as the living area unfolds.

www.spaceconstructions.com.au

2017 HIA AUSTRALIAN DISPLAY HOME FINALISTS

Kolak Living [ACT/Southern NSW](#)
Yarrum Designer Homes [Hunter](#)
New Homes Solutions Qld [North QLD](#)
Hudson Homes [NSW](#)
Tropical Lifestyle Homes [NT](#)
Regent Homes [SA](#)
Wilson Homes [TAS](#)
Grollo Homes [VIC](#)
Summit Homes [WA](#)

Partnered by



2017 | HIA AUSTRALIAN
PROJECT HOME

WINNER





WINNER: PLANBUILD HOMES Queensland

The Epernay project home presents a modern interpretation of the classic Hamptons' house style, perfectly designed to maximise the space of a smaller lot. The elegant, expansive five-bedroom home gives more than enough space for a family, with two large living areas on the ground floor offering access to a stunning entertainment area complete with an outdoor pool, spa and steam room. And the views...breathless.

www.planbuild.com.au



2017 HIA AUSTRALIAN PROJECT HOME FINALISTS

Classic Constructions [ACT/Southern NSW](#)

Rawson Homes [Hunter](#)

Keir Constructions [North QLD](#)

Fowler Homes [NSW](#)

Overlander Homes [NT](#)

Dechellis Homes [SA](#)

Wilson Homes [TAS](#)

Lucas Morris Homes [VIC](#)

The Rural Building Company [WA](#)

Partnered by



2017 | HIA AUSTRALIAN
SPEC HOME

WINNER



WINNER:

AVERNA HOMES

Western Australia

This street-smart modern Perth home cleverly balances dark and light tones with its crafted timbers and distinctive renders. Meticulously built with a design that will gracefully age, the home's two-storey façade of white porcelain contrasts with a horizontal black-rendered feature, and cedar board lined eaves. Sharp lines and striking colour palette are reminiscent of renowned architect, Frank Lloyd Wright.

www.avernahomes.com.au

2017 HIA AUSTRALIAN SPEC HOME FINALISTS

Viscon Homes & DNA Architects

ACT/Southern NSW

Hudson Homes Hunter

Statement Homes North QLD

Binet Homes NSW

Planet Homes QLD

Argent Constructions SA

Blackley Builders TAS

Partnered by

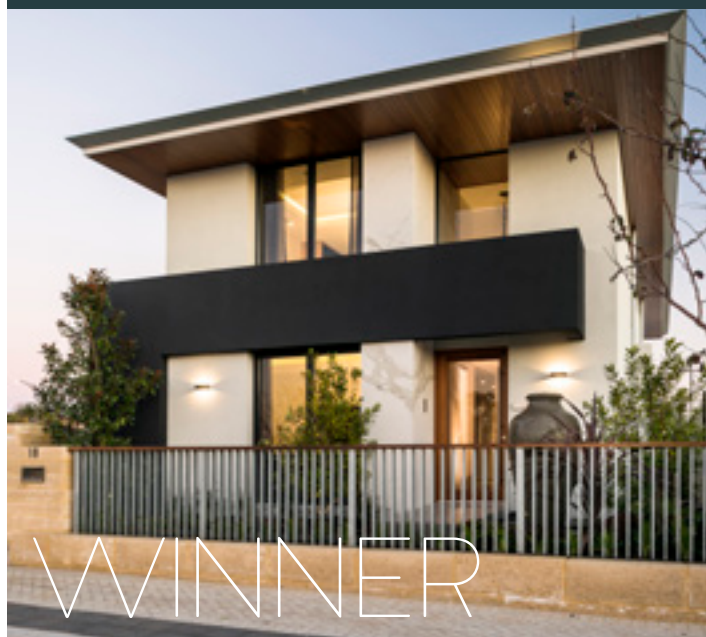

2017 | HIA AUSTRALIAN RENOVATION/ADDITION PROJECT WINNER





WINNER:

JW CONSTRUCTIONS (QLD) Queensland

A show-stopper both in skill and sophistication. An expansive cantilevered roof and balcony impresses on arrival. Entering the home's light and bright atmosphere will delight and beg exploration, offering plenty of areas which incorporate clever design. Floor-to-ceiling windows and the open plan layout drink in the coastal views making entertaining a breeze, as you look out onto the wet-edge pool.

www.jwconstructionsqld.com.au

2017 HIA AUSTRALIAN RENOVATION/ ADDITION PROJECT FINALISTS

Manteena, Steve Andrea Architecture
& Karin McNamara Design [ACT/Southern NSW](#)
Croese Building [Hunter](#)
A & C Constructions NQ [North QLD](#)
Pemell Lane Holdings
& Pemell Newtown Holdings [NSW](#)
DN Building [NT](#)
South Coast Constructions [SA](#)
Cordwell Lane [TAS](#)
Neumode Design & Construction [VIC](#)
Tallwood Constructions [WA](#)

Partnered by

Colorbond®
THE COLOURS OF AUSTRALIA SINCE 1966



2017 | HIA AUSTRALIAN TOWNHOUSE/VILLA OF THE YEAR WINNER



WINNER:

ELLIOTT PROJECTS

New South Wales

This contemporary four-bedroom townhouse sits in a leafy Sydney suburb, offering a smartly designed to offer a spacious and light-filled interior. It stands apart from neighbouring terraces with its stacking windows, fully recessed into pockets and a welcoming handmade timber door entrance, set off by timeless zinc panel cladding.

The build was challenging: neighbouring properties had to be underpinned but the evidence is beautifully masked with a large stone retaining wall – a prominent feature to the sunny rear courtyard.

www.elliottprojects.com.au

2017 HIA AUSTRALIAN TOWNHOUSE/ VILLA OF THE YEAR FINALISTS

Bellevue Building & DNA Architects

ACT/Southern NSW

Mavid Construction Hunter

Eastbuild Designer Homes North QLD

Killarney Homes NT

Ausmar Homes QLD

Cunic Homes TAS

HiSpec Homes VIC

VM Building WA

Partnered by



2017 | HIA AUSTRALIAN APARTMENT OF THE YEAR

WINNER





WINNER:

HELM

New South Wales

The HIA Australian Apartment of the Year is part of a mixed use development in Sydney's inner west, meticulously crafted with attention given to the smallest details.

The 244-square metre three-bedroom apartment promotes cross-ventilation and great acoustics for the resident's comfort. Well-positioned windows and sunshades offer views as well as privacy.

High 3.6-metre ceilings with skylights, well-polished limestone flooring, marble benchtops in the kitchen were considered standout elements by the judges.

www.helmproperties.com.au



2017 HIA AUSTRALIAN APARTMENT OF THE YEAR FINALISTS:

Condev Construction **QLD**

Blythe & Watchorn Builders **TAS**

May Constructions **VIC**

Macri Exclusive Homes **WA**

Partnered by



2017 | HIA AUSTRALIAN TOWNHOUSE/ VILLA DEVELOPMENT

WINNER



WINNER:

VIRGON CONSTRUCTIONS

Victoria

Beautiful finishes are complemented by exceptional craftsmanship across three levels in this upmarket townhouse/villa development in Melbourne's inner suburbs. This contemporary design includes a private lift in each of the four townhouses pushing the luxury and functionality element to new dimensions.

Natural materials provide a relaxed tone, from the timber screens to concrete feature walls to the gas fireplaces. Locally-sourced materials were used where possible, ensuring the project's overall embodied energy footprint was minimised.

www.virgon.com.au

2017 HIA AUSTRALIAN TOWNHOUSE/ VILLA DEVELOPMENT FINALISTS

Bellevue Building & DNA Architects

[ACT/Southern NSW](#)

Living Green Designer Homes [Hunter](#)

Eastbuild Designer Homes [North QLD](#)

Steele Associates [NSW](#)

Killarney Homes [NT](#)

Sunland Group [QLD](#)

APS Homes [SA](#)

SJM Property Developments [TAS](#)

West-Ville Constructions [WA](#)

Partnered by



2017 | HIA AUSTRALIAN
APARTMENT COMPLEX

WINNER





WINNER:

ARIA PROPERTY GROUP Queensland

The 2017 HIA Australian Apartment Complex is an impressive 20-level building including six levels of car parking camouflaged by a luscious green wall, grown under unique conditions for sub-tropical Queensland climate.

The workmanship is exemplary. A gymnasium, automated theatre, and the rooftop pool and entertaining area – featuring a high pergola on the roof formed in laser cut panels that play with light – offer comfortable communal spaces.

The judges loved that this ‘wonderful place to live’, combining inner city convenience with smart commercial spaces.

www.ariaproperty.com.au

2017 HIA AUSTRALIAN APARTMENT COMPLEX FINALISTS:

CHC ACT/Southern NSW

HELM NSW

Central Equity VIC

Gold Style Homes & Pulse Property Solutions WA

Partnered by

FLEET
BETTER BUSINESS SENSE



2017 | HIA AUSTRALIAN
SPECIALISED HOUSING

WINNER



WINNER:

KEIR CONSTRUCTIONS

North Queensland

Thoughtful practicality for the present and future living requirements of the owner is shown throughout this visually appealing, purpose-built suburban house.

The open plan design is wheelchair-friendly with seamlessly-levelled floors connecting all internal and external areas. A wide stacker door opens to a large rear entertaining patio overlooking the pool, built with a sunken ramp.

The judges said the charming space displays a high standard of workmanship and the builder's creativity to improve function.

www.keirconstructions.com.au

2017 HIA AUSTRALIAN SPECIALISED HOUSING FINALISTS:

Rettke Builders/Sketch Design [ACT/Southern NSW](#)

GR Homes [Hunter](#)

Ausmar Homes [QLD](#)

Rossdale Homes [SA](#)

Wilson Homes [TAS](#)

Glenvill Project Construction [VIC](#)

Distinctive Homes WA [WA](#)

Partnered by



2017 | HIA AUSTRALIAN OUTDOOR PROJECT

WINNER



WINNER



WINNER: **WABNITZ HOMES** South Australia

A luxurious seven-bedroom home required a remarkable outdoor space to fulfil an entertainer's dream. Timber decking integrated over multiple levels offers beach-vibe walkways connecting a tennis court and an in-ground pool, with a concrete aggregate surround, to other entertaining areas.

The judges said the outstanding attention to detail is showcased in the turtle pond with feature falls cleverly incorporated into the retaining walls, and the tiled gas-heated infinity pool on the third floor offering a stunning backdrop to city and sea views.

www.wabnitzhomes.com.au

2017 HIA AUSTRALIAN OUTDOOR PROJECT FINALISTS

ACT Decks [ACT/Southern NSW](#)
Millbrook Homes [Hunter](#)
Nixon Build [North QLD](#)
Millbrook Homes [NSW](#)
Abode New Homes [NT](#)
Antech Constructions [QLD](#)
Botanic Resources [TAS](#)
AM Precision Builders [VIC](#)
Lomma Homes [WA](#)

Partnered by



2017 | HIA AUSTRALIAN
KITCHEN DESIGN

WINNER



WINNER: SUBLIME ARCHITECTURAL INTERIORS Queensland

From the origami pendant lights to the silver acrylic-encased island benchtop, there is plenty to admire in this beautiful kitchen.

The linear design seamlessly integrates the inside of the home, with the outdoor component of the kitchen.

The mixtures of grey tones contrast with the timber detailing, showing the thoughtful use of multiple materials and the superior attention to the technical details needed to execute this design.

www.sublimegroup.com.au

2017 HIA AUSTRALIAN KITCHEN DESIGN FINALISTS

MMM Interiors [ACT/Southern NSW](#)

Apollo Kitchens [Hunter](#)

MyStyle Homes (QLD) & Pacific Kitchens [North QLD](#)

Kitchens By Design & Millbrook Homes [NSW](#)

Tropix Homes [NT](#)

TK Design Kitchens Bathrooms Interiors [SA](#)

Impact Kitchens [TAS](#)

Marklew Housing [VIC](#)

Mata Design Studio [WA](#)

Partnered by



2017 | HIA AUSTRALIAN KITCHEN OF THE YEAR

WINNER





WINNER: ENIGMA INTERIORS Queensland

This sophisticated kitchen is sure to impress.

Its standout feature – a detailed splashback of mosaic tiles, displaying vibrant creativity, skilled and patient workmanship. The judges said this unforgettable element works as a piece of art for the open plan living room.

Beautifully executed, other features include: full appliance integration; a working butler's pantry with stainless steel benchtops and an additional oven for the caterer in the family; and booth-style seating for entertaining or everyday living.

www.enigmainteriors.com.au

2017 HIA AUSTRALIAN KITCHEN OF THE YEAR FINALISTS

Braithwaite Innovative Joinery & Preferred Builders
[ACT/Southern NSW](#)

Williams Designer Homes & Groves Joinery [Hunter](#)

Campbells Kitchen Cabinets [North QLD](#)

Millbrook Homes & Maluna Joinery [NSW](#)

Forrest Building Co [NT](#)

Space Craft Joinery [SA](#)

Hodgman Kitchens & Cabinets [TAS](#)

Head Homes [VIC](#)

International Cabinets [WA](#)

Partnered by



2017 | HIA AUSTRALIAN BATHROOM DESIGN

WINNER



WINNER:

MINOSA

New South Wales

A respectful approach to its 1920s origins with minimalist features achieved a stylish bathroom for this renovated home.

A blade wall conceals a walk-in shower and a free standing bath maximising the space in this heritage building. The mirrored cabinet set off the wall and backlit with task LED lighting creates a romantic ambiance.

The charcoal patterned tiles appear like wallpaper and perfectly accentuate the bespoke timber finishes.

www.minosadesign.com

2017 HIA AUSTRALIAN BATHROOM DESIGN FINALISTS

Sugar Designs [ACT/Southern NSW](#)

Millbrook Homes [Hunter](#)

Keir Constructions [North QLD](#)

Tropix Homes [NT](#)

Mosaic Construction [QLD](#)

Outside Square [SA](#)

d'Eco Design [TAS](#)

Bubbles Bathrooms [VIC](#)

Weststyle Design & Development [WA](#)

Partnered by

Caroma



WINNER



2017 | HIA AUSTRALIAN BATHROOM OF THE YEAR

WINNER





WINNER: CROESE BUILDING Hunter

A sumptuous ensuite with day spa ambitions.

Sliding glass doors open onto an atrium courtyard bringing in the outdoors and linking the master bedroom with natural light. The matte black fixtures and glass framing are softened by the warmth of the timber yet contrast beautifully with marble tiles. Frosted privacy panels that enhance the black accents, along with the thermostatic-controlled underfloor heating and the antique mirror tile feature wall, are all elements which add to this bathroom's luxurious nuance.

www.croesebuilding.com

2017 HIA AUSTRALIAN BATHROOM OF THE YEAR FINALISTS

Better Building Services & Sugar Designs
[ACT/Southern NSW](#)

CCW Cabinetworks [North QLD](#)

Fowler Homes [NSW](#)

Northern Star Homes [NT](#)

Sarah Waller Design [QLD](#)

Jaytex Designer Homes [SA](#)

WD Bryan Joinery House [TAS](#)

smarterBATHROOMS+ [VIC](#)

Seacrest Homes [WA](#)

Partnered by

Caroma

2017 | 2017 HIA JIM BROOKES AUSTRALIAN APPRENTICE



WINNER

WINNER: JAMES THOMPSON Queensland

James Thompson is a third-year apprentice carpenter who was keen to help his builder father on the tools from an early age. Carpentry came naturally to James who picked up the trade two years into his civil engineering degree. The highlight of his apprenticeship was a working trip to Canada as an apprentice ambassador. His leadership and communication skills, led him to an interest in mentoring new apprentices. With his motivation and drive James hopes to one day start his own firm focusing on high-end builds.

2017 HIA JIM BROOKES AUSTRALIAN APPRENTICE FINALISTS:

Jordan De Smeth ACT/Southern NSW

Benjamin Tunney-Portar Hunter

Dylan Murphy North QLD

Te Ngahoa Ataria NSW

Levi Ellis NT

Wade Bache SA

Drew Charlton TAS

Torby Alldridge VIC

Cody Versteeg WA

Partnered by



2017 | HIA AUSTRALIAN BUSINESS PARTNER



WINNER

WINNER:

MERYLESE MERECICA, BLUE ECO HOMES New South Wales

Merylese Mercieca is both a business manager and WHS nurse for Blue Eco Homes. The judges said she is 'a veritable powerhouse', one who guides and provides strong direction across every facet of the business.

The business suffered an enormous blow when a bushfire destroyed their premises in 2013. Merylese was a key driver in the recovery, which could have signalled the end of the business. Merylese implemented ISO certification across the business, all while managing a work-life balance that involves an extraordinary commitment to volunteering within the community.

www.blueecohomes.com.au

2017 HIA AUSTRALIAN BUSINESS PARTNER FINALISTS

Rebecca Hopper, PAH Innovative Construction [ACT/Southern NSW](#)

Rebecca Sharpe, Mavid Construction [Hunter](#)

Deborah Noonan, Bill & Ben The Cabinet Men [North QLD](#)

Kylee Kassiou, Vanguard Homes [NT](#)

Danielle Berry, Brisbane Bathroom Renovations [QLD](#)

Elise Heyes, BTF Constructions [SA](#)

Cherie Dance, PA Dance Builders [TAS](#)

Maria Quaglia, Aquila Homes [WA](#)

Partnered by 



2017 | HIA AUSTRALIAN PROFESSIONAL MAJOR BUILDER

WINNER



WINNER: PORTER DAVIS Victoria

Porter Davis' recent initiatives, including a major cultural workplace transformation, indicate a renewed focus on continuous improvement and respect for its customers.

Employing 500 staff and 1300 contractors, the business leaves an excellent impression of customer focus. In the past year new customer service improvements include complimentary 12 months RACV Emergency Home Assist, a design review team, and feedback and resolution channel. Its World of Style showroom, mobile apps and social media engagement indicate efforts for experiential and innovative business experiences.

www.porterdavis.com.au

2017 HIA AUSTRALIAN PROFESSIONAL MAJOR BUILDER FINALISTS:



Partnered by

McDonald Jones Homes **Hunter**
Eden Brae Homes **NSW**
Plantation Homes **QLD**
Metricon Homes **SA**
Wilson Homes **TAS**
Dale Alcock Homes **WA**

PORTER DAVIS

2017 | HIA AUSTRALIAN PROFESSIONAL MEDIUM BUILDER/RENOVATOR

WINNER



WINNER:

KILLARNEY HOMES
Northern Territory

Killarney Homes' strong vision to build the best in energy-efficient homes for the tropics underpins the business' strategic plans.

The business gains a deep knowledge of its customer requirements through a collaborative approach. Maintaining a detailed database helps to manage daily business activities, deliver reporting and analysis to determine better marketing strategies, and to segment clients for more tailored experiences.

The business has recently invested heavily to internalise drafting and design capabilities.

www.killarneyhomes.com.au

**2017 HIA AUSTRALIAN PROFESSIONAL
MEDIUM BUILDER/RENOVATOR FINALISTS:**

Partnered by **Companion**
Systems

Montgomery Homes **Hunter**
Grady Homes **North QLD**
Marksman Homes **NSW**
Bold Properties **QLD**
Format Homes **SA**
Ronald Young & Co Builders **TAS**
Englehart Homes **VIC**
Summit South West **WA**



2017 | HIA AUSTRALIAN PROFESSIONAL SMALL BUILDER/RENOVATOR

WINNER



2017 HIA AUSTRALIAN PROFESSIONAL SMALL BUILDER/RENOVATOR FINALISTS:



Build Professional ACT/Southern NSW
Ferris Building Hunter
Nixon Build North QLD
Blue Eco Homes NSW
Heisig Constructions (Qld) QLD
Serenity Homes SA
PA Dance Builders TAS
Coastyle Building Solutions VIC
Humphrey Homes WA

WINNER:

ABODE NEW HOMES
Northern Territory

Abode New Homes' growth over 16 years shows that flourishing success comes from innovation and a drive to develop the best business model for new home building.

The family business values customer service highly, with staff completing external relationship training, while client liaison officers and a login portal ensure communication lines are always open during the build process.

The judges were also impressed by Abode's commitment to talking to schools about industry careers, or placing work experience students to try out a trade.

www.newabode.com.au





PARTNERS | 2017





CSR is the name behind some of the market's most trusted and recognised brand names in providing building products for residential and commercial construction. Names that builders and generations of Australians have come to know and trust. Like Gyprock® plasterboard, Cemintel™ fibre cement systems, Bradford™ insulation, PGH™ bricks and pavers, Monier™ rooftiles, Hebel® aerated concrete, Viridian™ glass and AFS load bearing walling systems to name a few.

CSR will continue to invest in product innovation, delivering the building systems which will make building faster and easier to use.

We look forward to this continued partnership with HIA and would like to congratulate all the 2017 award nominees and winners for their hard work and dedication.

www.csr.com.au



2017 | MAJOR PARTNER



The year 1984 saw Advanced Australia Fair become our National Anthem, the 1 dollar coin come into circulation, and a small family air conditioning business open its doors. Today, ActronAir is a proud Australian company recognised for making world-class air conditioners. Well, it stands to reason. The team at ActronAir experience our harsh Australian conditions first hand, and our climate places demands on air conditioning not found in other parts of the world.

That's why ActronAir's engineers have developed the most advanced air conditioning systems specifically for the unique and harsh Australian climate. Spanning from 2kW Wall Hung Splits to 200kW Packaged Units and everything in between, ActronAir's deep product range ensures we can provide the right solution for your comfort.

It's better air conditioning for how Australians really live.

www.actronair.com.au



Caltex Australia offers exceptional value to HIA members providing access to the largest network of service stations nationally.

Through the use of StarCard, HIA members have better value at more locations than any other provider. Caltex offers HIA members access to benefits such as exclusive discounts, reduced fees and the ability to simplify fuel purchasing and account management. At Caltex we supply over one-third of all Australia's transport fuels and is ideally placed to be the preferred fuel partner to the HIA and their members.

www.caltex.com.au



Australia's iconic bathroomware brand Caroma brings form to function and design to dependability, helping you create the perfect bathroom solution. Driven and committed to delivering world-class quality and ingenious design solutions, in a style that's distinctly Australian. The Caroma signature has inspired Australians for over 75 years.

At Caroma, everything we create is crafted to strict quality guidelines and backed by local service and support. We test our products beyond industry standards and are relentless in our pursuit of innovation and engineering excellence.

With specialist advice, and the latest in design and innovation, we are proud to offer comprehensive bathroom solutions for both residential and commercial projects. Discover more at specify.caroma.com.au

www.caroma.com.au

PARTNERS | 2017



BlueScope are proud to be an ongoing HIA partner and support the Association's role as the voice of Australia's home building industry. BlueScope's industry leading brands, COLORBOND® steel and TRUECORE® steel continue to play a key role in Australian housing. The attributes that have built these brands, such as world class quality, durability, technical backup and support will continue to help create beautiful homes and inspire confidence in the future, just as they have done in the past. 2016 marked the 50th year for COLORBOND® steel in Australia's building and construction industry, and will be a time to celebrate all the great homes that have been built in the past, while imagining the new and innovative designs of the future.

www.bluescope.com



Companion Systems developed the OnSite Companion software system for the construction industry. This Workflow Management, Task Scheduling and Document Management solution manages all aspects of a build – from sales through construction to warranty. It is designed for builders with office and on-site staff and works online in real-time and offline when fast internet access is not available. Management, Supervisors and Administration staff see all tasks, progress, documents, pictures, communications (including all emails) and WHS aspects pertaining to a job.

The system manages updates to your custom client portal website and integrates with a number of estimating and accounting solutions. OnSite Companion is the solution of choice for builders looking to grow results without growing costs. Let us help you grow.

www.companionsystems.com.au



Holcim operates right across Australia supplying building & construction materials from a network of more than 160 concrete plants, 900 mixer trucks, 40 quarries, 13 Humes precast manufacturing plants, and mobile and on-site contracting facilities.

They offer an extensive array of premix concrete products designed to achieve specific properties based on their application, transport and construction requirements. Mobile concrete batching and on-site operations service major projects and remote rural communities. Holcim's product offer is supported by an extensive range of technical and testing services.

Increasingly there is a need for higher performance and consumer products. As such Holcim provides a large product range comprising specialized value-added products such as environmentally sustainable solutions, high performance, specification concrete and its Geostone range of decorative concrete for internal & external applications.

www.holcim.com.au

2017 | PARTNERS



At HIA Insurances Services we understand that your business is your livelihood. We realise how important it is to partner with the right Broker who understands your business and has quality tailored products that protect the risks that you face on the job day in and day out.

You only know if you have good insurance when you need to use it. As your broker we manage your claim with the insurer on your behalf. Our team have extensive knowledge about the claim handling process to save you time and help you achieve the best possible claim outcome. Call us on 1800 633 467.

www.hiainsurance.com.au



James Hardie is a leading international company specialising in the manufacture of fibre cement building products. Over ninety five percent of James Hardie's products are Australian made, and as a result of sustained growth, James Hardie has investing more than \$90 million expanding manufacturing operations in Carole Park, Queensland.

Much of the company's growth comes from the premium range of Scyon™ cladding and flooring products. These innovative products were developed locally, in James Hardie's research and development facility in Rosehill. The company's fibre cement products are used in new detached and medium density residential construction, renovations and a variety of commercial and industrial applications.

James Hardie™ is committed to manufacturing sustainable building products.

www.jameshardie.com.au



Since the company was founded in 1899, Miele has remained true to its 'Immer Besser' brand promise. This means that we will do all that we can to be 'forever better' than our competitors and 'forever better' than we already are. Miele has always held a commitment to sustainability and this continues to apply today.

Miele is the world leader in premium domestic appliances. Renowned for their futuristic clean-lined style and technological innovation, today these appliances are represented by the impeccable fleet design of Miele's Generation 6000 range.

Miele appliances immediately elevate the status of a project, distinguishing it as head and shoulders above the rest. But communicating quality by associating your brand with the Miele brand and maximising buyer appeal is only part of the story.

www.miele.com.au

PARTNERS | 2017

 newhomesguide.com.au



newhomesguide.com.au is the home of digital marketing help for Australia's new homes sector and the only dedicated new homes website proudly supported by the HIA. The platform helps the country's best builders and developers attract and engage with consumers online. For consumers, the site is the best place to find new homes, building companies, and plenty of helpful content.

Since 2011, newhomesguide.com.au has evolved into the leading digital marketing platform, with constant growth in site traffic and consumer engagement.

The platform is always adding new features and functionality to stay in front, maintain growth and find new ways to present builders and their homes to thousands of consumers every day.

www.newhomesguide.com.au



For over 80 years, OneSteel Reinforcing has helped build Australia. We've been the backbone of Australian Residential construction.

Customers rely on OneSteel Reinforcing for Australian-made, top quality products that meet all Australian standards. OneSteel Reinforcing products have stood the test of time in our homes and pools, through to high rise constructions.

Customers trust us to provide what they need, where and when they need it. They rely on us scheduling and technical advice based on real experience.

In addition, OneSteel Reinforcing has developed a range of innovative solutions to streamline your next project, with time, cost and labour savings.

www.reinforcing.com



Rheem is Australia's favourite name in hot water. Since the 1930s, generations of Australian families have relied on Rheem for water that is steady, hot and strong!

Rheem began operations in Australia in 1936 as an overseas venture of Rheem Manufacturing, an American drum manufacturer. In 1939, Rheem Australia manufactured its first gas water heater in the inner Sydney suburb of Waterloo and production of electric water heaters commenced in 1945.

Over the years, the Rheem product range has diversified to include the latest in solar, heat pump and high efficiency gas water heaters. Today, Rheem Australia is the market leader in the Australian water heater industry, with a focus on design, manufacture and delivery of customer-focused, cost effective water heating solutions.

www.rheem.com.au

2017 | PARTNERS



Stramit Building Products is a major Australian manufacturer of roll-formed steel building products, including roof and wall cladding, guttering, fascia, purlins, flooring and structural formwork. These products, along with complementary products and services, are delivered through a nationwide network of manufacturing and distribution centres, each one strategically located to ensure coverage of major metropolitan and regional markets.

Stramit Building Products' vision is to become the leading building products and steel solutions business across Australia. This goal is driven by shared values of Be Bold / Play Fair / Better Every Day / and Customer Leading – to provide a safe and fulfilling working environment for all employees. Stramit is a member of the Fletcher Building Group.

www.stramit.com.au



Stratco Australia is an Australian-owned retailer, manufacturer and marketer of building and hardware solutions. For over 68 years we have supplied our comprehensive range of quality products to consumers, the building/construction industry, and our trade customers across the country.

Today, Stratco has sophisticated manufacturing facilities throughout Australia, a growing network of award winning retail outlets, and a team of professional trade representatives offering a superior level of customer service and local know how.

With a dedicated Research & Development department, an experienced engineering team and industry leading material and structural testing facilities, Stratco continues to innovate, engineer, manufacture and test a wide range of new products to Australian standards for local conditions.

www.stratco.com.au



Toyota Australia is a leading manufacturer, distributor and exporter of vehicles providing a wide range of vehicles to the Australian Market. Toyota Fleet are committed to delivering Quality, Safety and Innovation in everything they do; while at the same time finding ways to improve. As a partner of the Housing Industry Association, Toyota Fleet continues to offer HIA Members our National Gold Fleet Discount.

www.toyota.com.au/fleet

PARTNERS | 2017



you're in good hands