

Quilt



Designer Ruby™

Approximate Size 58" x 58" (147 x 147 cm)

Sewing Supplies:

- 1 ½ yards of 55" wide (120 x 140 cm) white fabrics for center piece
- 1 1/8 yards of 55" wide (95 x 140 cm) dark red fabric for inner border and binding
- 1/4 yard (15 cm) each of 11 different red and pink quilt fabrics for outer border
- 1 2/3 yards of 60" wide (150 x 150 cm) Beige cotton fabric for backing
- 1 2/3 yards of 60" wide (150 x 150 cm) Cotton batting
- Sewing thread
- 40 wt Embroidery thread
- Bobbin thread
- Tear away stabilizer
- 45mm Rotary Cutter
- Ruler 6" x 24"
- Cutting mat
- Safety Pins for "basting" the Quilt

HUSQVARNA VIKING®

Sewing Machines and Accessories

- HUSQVARNA VIKING® DESIGNER RUBY™ Sewing and Embroidery Machine
- DESIGNER™ Royal Hoop 360 x 200mm (412 94 45-01)
- DESIGNER™ Crown Hoop 260 x 200mm (413 11 65-01)
- DESIGNER™ Splendid Square Hoop 200 x 200mm (412 96 82-01)
- Interchangeable Dual Feed (920 219-096)
- Changeable ¼" Guide Foot (413 23 83-45)
- Pictogram Pen (4120838-48)
- INSPIRA® Embroidery Needle Size 75 (620 07 17-96)
- Clear ¼" Piecing Foot with Guide (412 92 74-45)
- Clear Edge/Joining Foot (413 05 84-45)

You can find these and many other accessories in the HUSQVARNA VIKING® Accessory User's Guide or on our website www.husqvarnaviking.com, for purchase at your nearest HUSQVARNA VIKING® Dealer.

1/4" (6 mm) seam allowance is included in all measurements.

Cut:

White fabric

- One – 48" x 48" (120 x 120 cm) Quilt center

Dark red fabric

- Four – 1 1/2" x 55" (4 x 140 cm) Inner border
- Five – 3 1/4" x 55" (8 x 140 cm) Binding
- Four – 1/8yd x 1/8yd (12 x 12cm) corner squares on the outer border

Red and pink fabric

- Three – 1 3/8" x 45" (3.5 x 115 cm) strips of each 11 colors for outer border

Backing

- 60" x 60" (150 x 150 cm)

Batting

- 60" x 60" (150 x 150 cm)

Embroider the white center fabric piece:

1. Attach the embroidery unit and Clear Embroidery Foot R. Thread the machine with embroidery thread on top and bobbin thread in the bobbin.
2. Select design 18, 19, 21, 22 and 23 from the embroidery designs that come with your DESIGNER RUBY™.
3. Bring the design into your 5D™ Embroidery Software and print paper templates of the embroideries for placement of all embroideries.
4. Lay out the printed paper template pieces on the 1 ½ yd x 48" (120 x 120 cm) white center piece to create a heart shape according to the quilt diagram.



5. Hoop the white center piece with stabilizer and use Design Positioning to place the embroideries exactly where you want them. The fabulous Design Positioning feature on the DESIGNER RUBY™ sewing and embroidery machine means you can match your embroideries perfectly even after hooping the fabric. Consult your User's Guide for more information

- Start to embroider from the top right side of the heart shape and down with 4 embroidery designs.

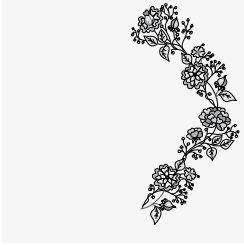

- Continue in the same way with 4 embroidery designs on the left side of the heart shape.



- End the heart embroidery with 2 small designs on top and lower tip of the heart shape as illustration. Tear away the stabilizer. Press.



Sewing:

- Thread your HUSQVARNA VIKING® DESIGNER RUBY™ with sewing thread on the top and in the bobbin. Snap on your Quilter's 1/4" Piecing Foot. Choose Woven light and Seam on your Sewing Advisor or select a straight stitch, length 2.0.
- Pin and stitch two 1 3/8" x 45" (3.5 x 115 cm) strips right sides together lengthwise. Pin and stitch another strip to the long side of one of the sewn strips. Alternate different colors. Continue sewing as above until 33 strips are sewn into one piece. Press the seam allowance open.

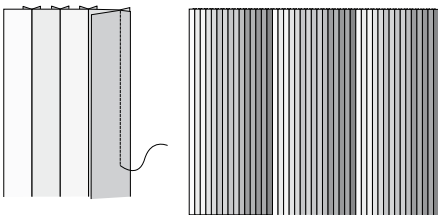

- Cut the quilt piece into 8 crosswise strips, 4 1/4" (12cm) wide.

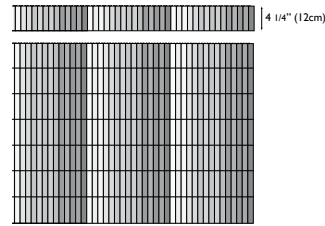

- Pin and stitch two 4 1/4" (12cm) wide crosswise strips short sides together. Press seam allowance open.

Sewing borders to quilt top

- Mark center of 48" x 48" (120 x 120 cm) white quilt top edge, bottom edge and both sides. Mark the center of each inner border strip.
- Pin the inner border strips to both sides of the quilt top, right sides together and matching center markings. Sew the border using 1/4" (6mm) seam allowance. Press seam allowance toward the outside. Trim the borders.

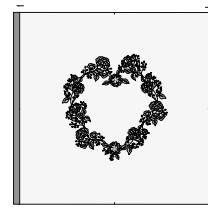

- Continue to pin the inner borders strip to the top and bottom for the quilt, matching the center markings on the border strip to the edges of the quilt. Sew the borders. Press seams toward the outside. Trim the borders.

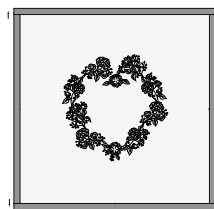

- Measure the length of the quilt and cut four strips of the 4 1/2" wide (12 cm) piece outer border.
- Sew two of the strips to both sides of your quilt. Press seams toward the inner border.

6. Sew a 4 1/2" (12cm) red square to the ends of the remaining 2 strips. Press and sew these strips to the remaining 2 sides. Give your quilt top a final press.

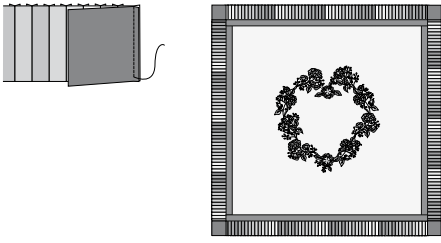

Quilt your Quilt:

1. Layer your quilt top, batting and backing forming a quilt "sandwich". The backing should be right side down, then the batting and the quilt top right side up on top. Safety pin baste the quilt through all the layers.
2. Select design 17 from the embroidery designs that come with your DESIGNER RUBY™.
3. Bring the design into your 5D™ Embroidery Software and print paper templates of the embroidery for placement of embroidery. Mirror image the design side to side and print a paper template.
4. Lay out the printed paper template pieces inside the embroidered heart shape on the 48" x 48" (120 x 120 cm) white center piece to create a quilted heart according to the illustration.

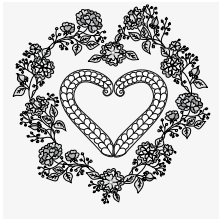

5. Hoop the right side of the design and use Design Positioning to place the embroideries exactly where you want them in the hoop. Embroider the design.
6. Mirror image the embroidery side to side. Continue to embroider in the same way on the left side of the quilt heart.

7. Set the sewing machine to sewing mode. Change to Interchangeable Dual Feed and snap on the Changeable 1/4" Guide Foot. Thread your machine with regular sewing thread on top and in the bobbin. Select a straight stitch and channel quilt lines 1" (2.5cm) apart on the center section as illustrated.

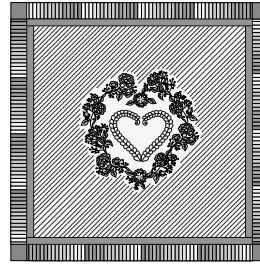

8. Snap on your B foot. Select a 3 Step Zig Zag and stitch around the edge of the quilt top. Trim the excess backing and batting even with the edge of the quilt top.

Binding:

1. Sew the binding strips together into one long strip. Press the seams open. Fold the binding in half lengthwise, wrong sides together, and press.
2. Place the binding on the right side of the quilt with the raw edges even. Snap on your Quilter's 1/4" Piecing Foot. Stitch the binding in place around the quilt. Fold the folded edge of the binding to the wrong side of the quilt and stitch in the ditch from the right side with the Edge/Joining foot and sewing thread on top and bottom.

