



# BATHROOM MIXERS

SPRING RELEASES - 2015



[dorf.com.au](http://dorf.com.au)



# TRUSTED



Over the years we've built a reputation as leaders in our field. Yet we are equally proud to know that every day our customers have come to rely on the Dorf name to stand for quality, beauty and craftsmanship.





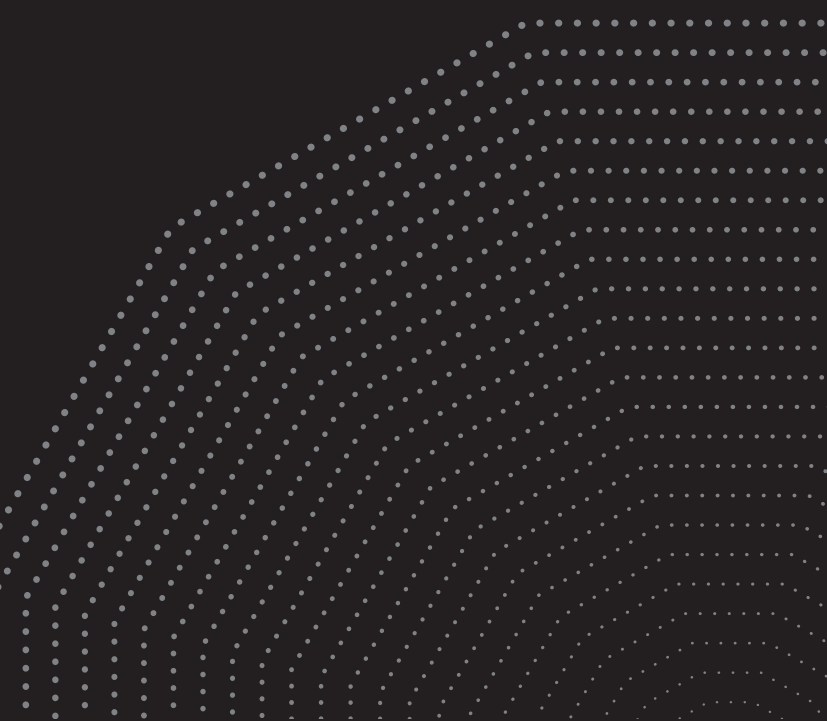

# EVOLVING

---

The world is changing, fast. As well as being on top of the latest technological innovations we constantly look for the best and most current ideas in design, beauty and art. Because at Dorf it's always about how we can live... better.

---

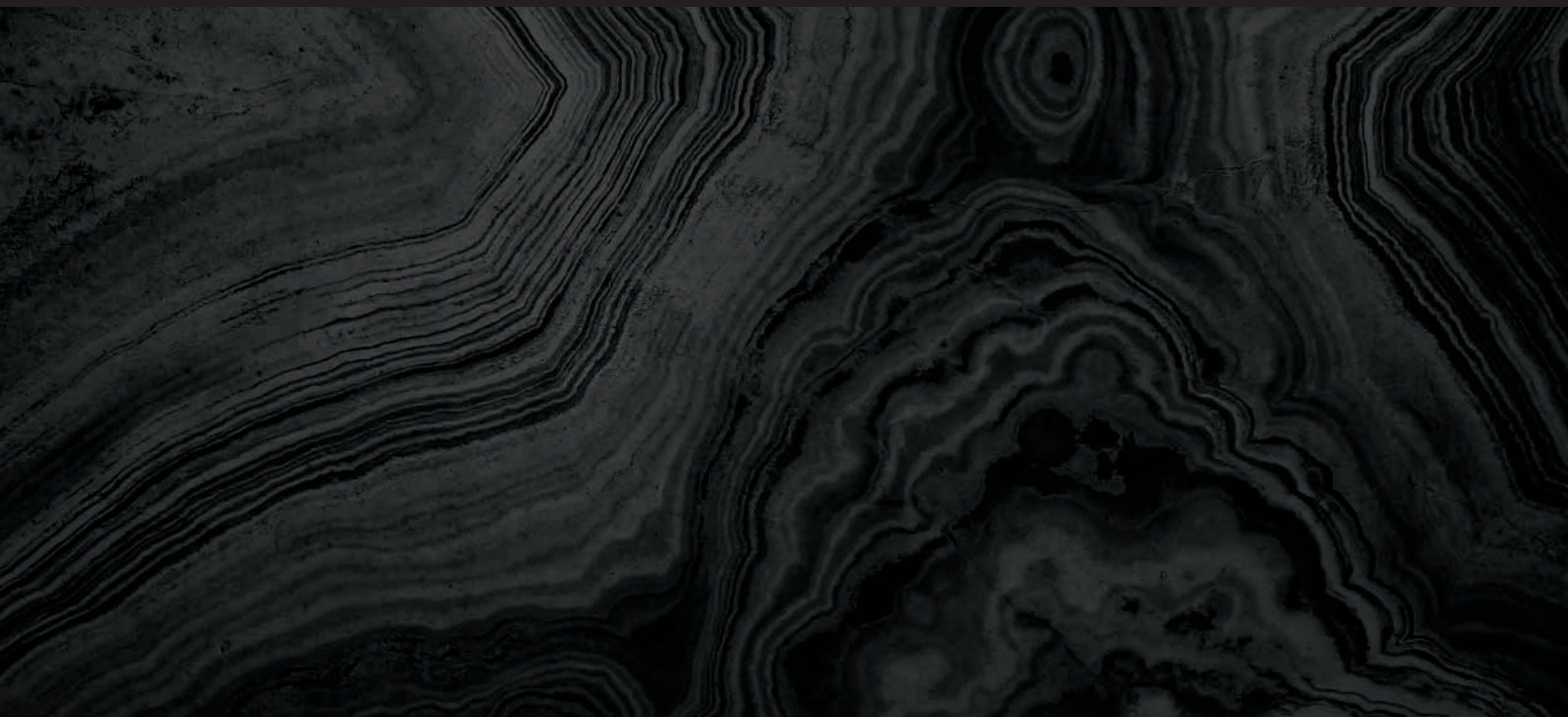

# INDUSTRIE

## MIXERS



Industrie Basin Mixer - Red Handles 6101.045A  
Matched above with  
Caroma Quinn 570 Under Counter Basin





Industrie Tower Basin  
Mixer - Red Handles  
6201.045A

Proud individualists and fans of the industrial look will love Dorf Industrie.

Featuring exposed twin tap handles in red, black or white, the look is confident, robust and shamelessly distinctive.

- WELS 5 star rated, 6L/min
- European 1/4 turn ceramic disc cartridges
- European Ultraflex PEX hoses provide superior durability, ultimate flexibility and are free from impurities
- Concealed vandal resistant cache aerator
- Match with Caroma Teo or Caroma Quinn Basin

Also available with  
White and Black handles

Industrie Basin  
Mixer - White  
Handles  
6102.045A

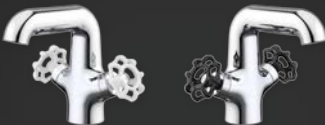

Industrie Basin  
Mixer - Black  
Handles  
6103.045A

Industrie Tower  
Basin Mixer -  
White Handles  
6202.045A



Industrie Tower  
Basin Mixer -  
Black Handles  
6203.045A

# ENIGMA

## MIXERS



Enigma Basin Mixer 6480.045A

Matched above with  
Caroma Liano Nexus Inset Basin





Enigma Bath/  
Shower Mixer  
6482.04



Enigma Tower  
Basin Mixer  
6481.045A

Enigma exudes a sense of wellbeing with its bold, geometric looks and sleek proportions.

Its strikingly signature design combines with a functional, robust quality, making it perfectly suited to the rigors of family life.

- WELS 5 star rated, 6L/min
- 35mm cartridge
- European Ultraflex PEX hoses provide superior durability, ultimate flexibility and are free from impurities
- Easy to clean silicone aerator prevents limescale
- Wall mounted taps feature unobtrusive, minimal back plates for an up to the minute look
- Match with Caroma Liano Nexus Basin range

Enigma Wall  
Basin/Bath Mixer  
6484.045A



Enigma Bath/Shower  
Mixer with Diverter  
6483.04





# NAPOLEON

## MIXERS

Napoleon Basin Mixer 6510.045A

Matched above with  
Caroma Urbane Semi Recessed Basin





Napoleon Bath/  
Shower Mixer  
6511.04

A fresh take on the classic bathroom mixer.

Napoleon's signature curves and elegant silhouette offer a welcome dash of character to the classic or traditional bathroom.

- WELS 5 star rated, 6L/min
- 35mm cartridge
- European Ultraflex PEX hoses provide superior durability, ultimate flexibility and are free from impurities
- Easy to clean silicone aerator prevents limescale
- Easy-mount, time saving basin mixer install
- Match with Caroma Urbane Basin Range

Napoleon Wall  
Basin/Bath Mixer  
6513.045A

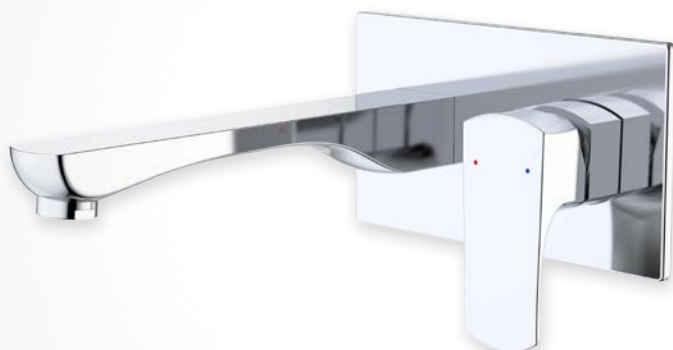

Napoleon Bath/Shower  
Mixer with Diverter  
6512.04



# VILLA

## MIXERS



Villa Basin Mixer 6901.045A

Matched above with  
Caroma Urbane Semi Recessed Basin





Villa Tower  
Basin Mixer  
6902.045A



Villa Bath/  
Shower Mixer  
6903.04

Villa's signature upswept angles are softened by its flattened, rounded lines, creating simple, enduring looks and a tangible sense of quality.

Villa is ideal for refreshing traditional or modern bathrooms.

- WELS 5 star rated, 6L/min
- 35mm cartridge
- European Ultraflex PEX hoses provide superior durability, ultimate flexibility and are free from impurities
- Easy to clean silicone aerator prevents limescale
- Easy-mount, time saving basin mixer install
- Match with Caroma Urbane or Cube Basin Range

Villa Wall Basin/  
Bath Mixer  
6906.045A



Villa Bath/Shower  
Mixer with Diverter  
6904.04



# HUGO

## MIXERS



Hugo Basin Mixer 6500.045A  
Matched above with  
Caroma Urbane Semi Recessed Basin





Hugo Bath/  
Shower Mixer  
6501.04

Hugo's balanced proportions are all about creating simple, timeless elegance.

Careful ergonomic styling and use of organic forms create an aerodynamic look and pleasing feel.

- WELS 5 star rated, 6L/min
- 35mm cartridge
- European Ultraflex PEX hoses provide superior durability, ultimate flexibility and are free from impurities
- Easy to clean silicone aerator prevents limescale
- Match with Caroma Urbane Basin Range

Hugo Wall Basin/  
Bath Mixer  
6540.045A



Hugo Bath/Shower  
Mixer with Diverter  
6502.04



# TECHNICAL INFORMATION

## INDUSTRIE

Basin Mixer 6101.045A - Red Handles  
6102.045A - White Handles  
6103.045A - Black Handles

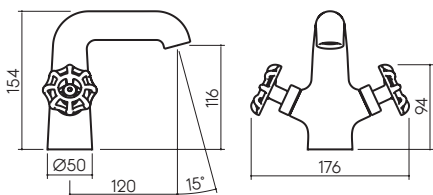

Tower Basin Mixer 6201.045A - Red Handles  
6202.045A - White Handles  
6203.045A - Black Handles

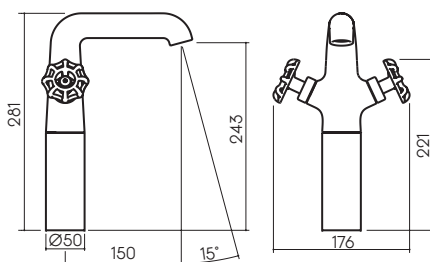

## ENIGMA

Basin Mixer 6480.045A

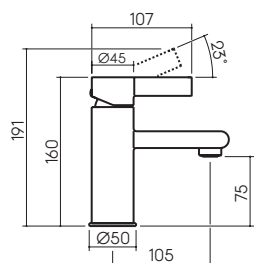

Bath / Shower Mixer 6482.04

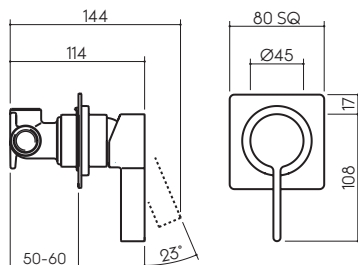

Tower Basin Mixer 6481.045A

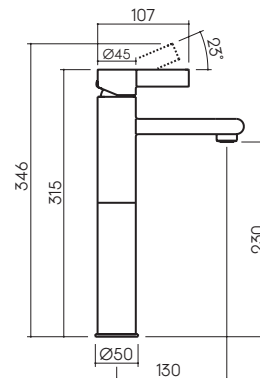

Bath / Shower Mixer w/ Diverter 6483.04

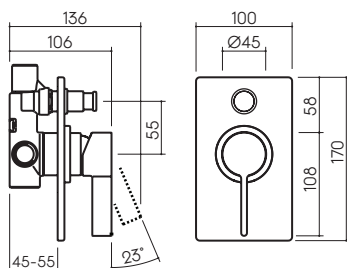

Wall Basin / Bath Mixer 6484.045A

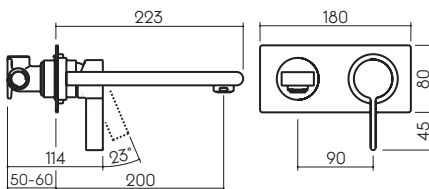

## NAPOLEON

Basin Mixer 6510.045A

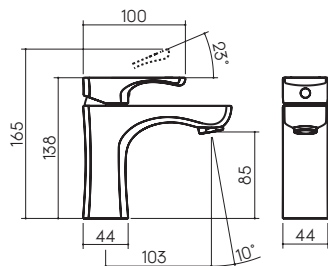

Bath / Shower Mixer 6511.04

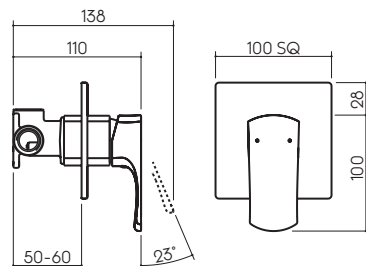

Bath / Shower Mixer w/ Diverter 6512.04

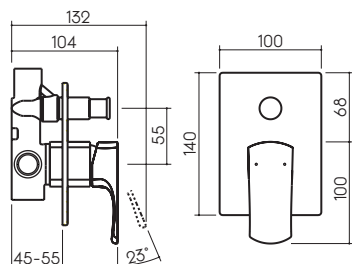

Wall Basin / Bath Mixer 6513.045A

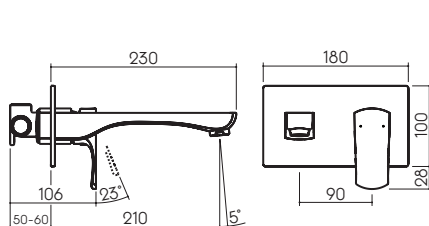



## VILLA

Basin Mixer 6901.045A

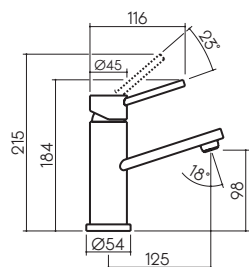

Bath / Shower Mixer 6903.04

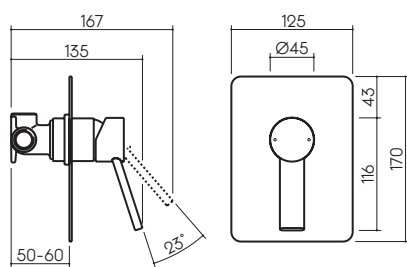

Tower Basin Mixer 6902.045A

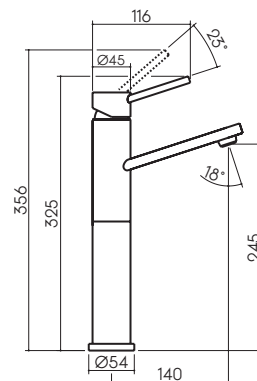

Bath / Shower Mixer w/ Diverter 6904.04

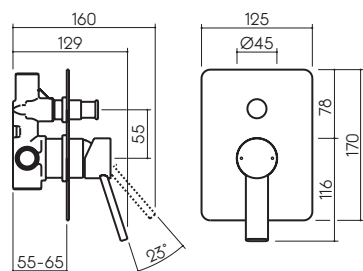

Wall Basin / Bath Mixer 6906.045A

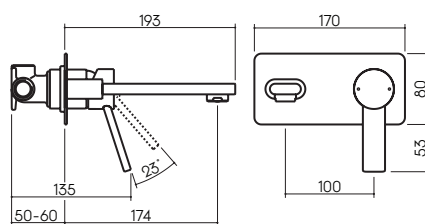

## HUGO

Basin Mixer 6500.045A

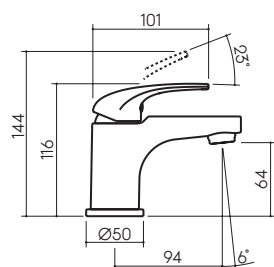

Bath / Shower Mixer 6501.04

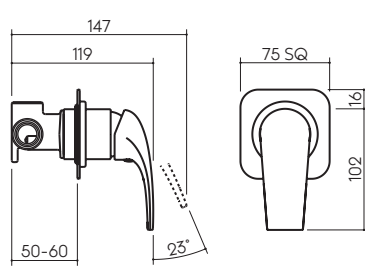

Bath / Shower Mixer w/ Diverter 6502.04

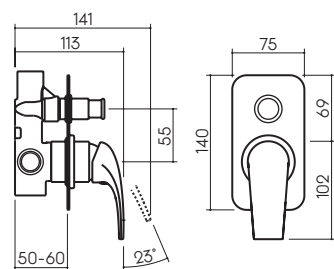

Wall Basin / Bath Mixer 6540.045A

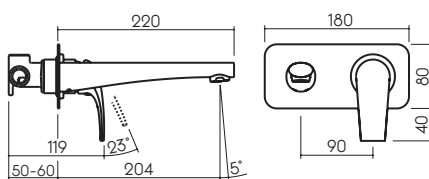



For more information call **13 14 16**  
or visit **[www.dorf.com.au](http://www.dorf.com.au)**



©Copyright 2015, Caroma Industries Ltd. ABN 35 000 189 499. All rights reserved. Material and design specifications subject to change without notice. Product colour reproduction is as near to actual product colour as production methods allow. Warning: Products in this flyer are the subject of registered designs and patents. ® is a registered trademark of Caroma Industries. This flyer relates to Australian products only and some product, design or specifications may differ in other countries.



**GWA**  
Bathrooms & Kitchens